

ENC Bearings

One colour for each temperature

as easy as that!



Specialists in high temperature

BRL Bearings SL is a distributor based in the Barcelona Region, we specialise in rotational solutions for high temperature applications predominantly in the bearing series of 6000,6200 and 6300 which can handle temperatures from 150°C to 330°C.

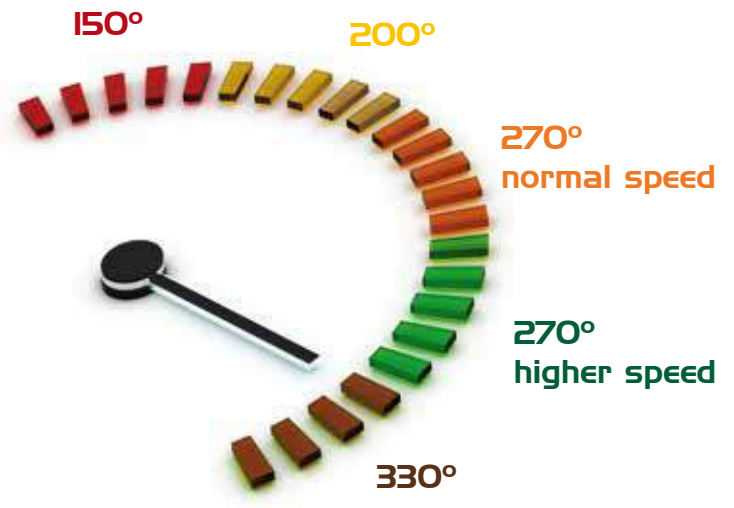

One colour for each temperature, as easy as that.

BRL has designed boxes in different colours for each product range according to their respective working temperatures, making it easier to identify and describe them in your warehouse..



**One colour for each temperature,
as easy as that.**



The company that brings
colour to temperature

6000 SERIES

Code	Inner diameter	Diameter (D)	Width (W)	Weight	Speed Revs./min.	Static charge Kn
6000 2RS ENC 150°C	10	26	8	20	10000	2,0
6001 2RS ENC 150°C	12	28	8	25	10000	2,4
6002 2RS ENC 150°C	15	32	9	30	10000	2,9
6003 2RS ENC 150°C	17	35	10	40	9000	3,3
6004 2RS ENC 150°C	20	42	12	69	8000	5,1
6005 2RS ENC 150°C	25	47	12	80	7000	5,8
6006 2RS ENC 150°C	30	55	13	120	6000	7,9
6007 2RS ENC 150°C	35	62	14	160	5000	10,3
6008 2RS ENC 150°C	40	68	15	190	4500	11,7
6009 2RS ENC 150°C	45	75	16	250	4000	14,1
6010 2RS ENC 150°C	50	80	16	260	3500	15,4

6200 SERIES

Code	Inner diameter	Diameter (D)	Width (W)	Weight	Speed Revs./min.	Static charge Kn
6200 2RS ENC 150°C	10	30	9	30	10000	2,6
6201 2RS ENC 150°C	12	32	10	37	10000	3,1
6202 2RS ENC 150°C	15	35	11	45	10000	3,8
6203 2RS ENC 150°C	17	40	12	65	9000	4,8
6204 2RS ENC 150°C	20	47	14	110	8000	6,6
6205 2RS ENC 150°C	25	52	15	130	7000	7,9
6206 2RS ENC 150°C	30	62	16	200	6000	11,1
6207 2RS ENC 150°C	35	72	17	290	5000	15,1
6208 2RS ENC 150°C	40	80	18	370	4000	17,8
6209 2RS ENC 150°C	45	85	19	410	3500	20,1
6210 2RS ENC 150°C	50	80	16	260	3500	15,6

6300 SERIES

Code	Inner diameter	Diameter (D)	Width (W)	Weight	Speed Revs./min.	Static charge Kn
6300 2RS ENC 150°C	10	35	11	52	10000	3,5
6301 2RS ENC 150°C	12	37	12	68	9500	4,2
6302 2RS ENC 150°C	15	42	13	80	9000	5,5
6303 2RS ENC 150°C	17	47	14	120	8000	6,6
6304 2RS ENC 150°C	20	52	15	140	7000	8,6
6305 2RS ENC 150°C	25	62	17	225	6000	11,3
6306 2RS ENC 150°C	30	72	19	350	5000	16,1
6307 2RS ENC 150°C	35	80	21	450	4000	18,8
6308 2RS ENC 150°C	40	90	23	620	3500	24,7
6309 2RS ENC 150°C	45	100	25	830	3000	31,6
6310 2RS ENC 150°C	50	110	27	1050	2500	37,5

2RS

ENC 2RS 150°

TECHNICAL CHARACTERISTICS

- AISI 52100 Steel
- C4 radial clearance
- Grease from -29° C to 170°C
- 150° Protection in vulcanised rubber

FIELDS OF USE

- Industrial fans
- Farm machinery
- Air transports
- Roller chains
- Etc.



TECHNICAL CHARACTERISTICS

- AISI 52100 Steel
- C₄ radial clearance
- Grease from -25° C to 200°C
- ZZ shields

FIELDS OF USE

- Industrial fans
- Packaging machinery
- Ceramic industry
- Roller chains
- Steel production
- Etc.



6000 SERIES

Code	Inner diameter	Diameter (D)	Width (W)	Weight	Speed Revs./min.	Static charge Kn
6000 ZZ ENC 200°C	10	26	8	20	6000	1,78
6001 ZZ ENC 200°C	12	28	8	25	5800	2,13
6002 ZZ ENC 200°C	15	32	9	30	5600	2,53
6003 ZZ ENC 200°C	17	35	10	40	5400	2,94
6004 ZZ ENC 200°C	20	42	12	69	5200	4,56
6005 ZZ ENC 200°C	25	47	12	80	4800	5,14
6006 ZZ ENC 200°C	30	55	13	120	4400	7,11
6007 ZZ ENC 200°C	35	62	14	160	4000	9,19
6008 ZZ ENC 200°C	40	68	15	190	3600	10,47
6009 ZZ ENC 200°C	45	75	16	250	3200	12,64
6010 ZZ ENC 200°C	50	80	16	260	2800	13,83
6011 ZZ ENC 200°C	55	90	18	390	2400	18,77
6012 ZZ ENC 200°C	60	95	18	420	2000	20,54

6200 SERIES

Code	Inner diameter	Diameter (D)	Width (W)	Weight	Speed Revs./min.	Static charge Kn
6200 ZZ ENC 200°C	10	30	9	30	5800	2,33
6201 ZZ ENC 200°C	12	32	10	37	5600	2,84
6202 ZZ ENC 200°C	15	35	11	45	5400	3,35
6203 ZZ ENC 200°C	17	40	12	65	5200	4,26
6204 ZZ ENC 200°C	20	47	14	110	4800	5,98
6205 ZZ ENC 200°C	25	52	15	130	4400	7,11
6206 ZZ ENC 200°C	30	62	16	200	4000	9,88
6207 ZZ ENC 200°C	35	72	17	290	3600	13,53
6208 ZZ ENC 200°C	40	80	18	370	3200	16,00
6209 ZZ ENC 200°C	45	85	19	410	2800	18,07
6210 ZZ ENC 200°C	50	90	20	460	2400	21,33
6211 ZZ ENC 200°C	55	100	21	610	2000	25,78
6212 ZZ ENC 200°C	62	110	22	780	1800	32,00

6300 SERIES

Code	Inner diameter	Diameter (D)	Width (W)	Weight	Speed Revs./min.	Static charge Kn
6300 ZZ ENC 200°C	10	35	11	52	5600	3,14
6301 ZZ ENC 200°C	12	37	12	60	5400	3,75
6302 ZZ ENC 200°C	15	42	13	80	5200	4,87
6303 ZZ ENC 200°C	17	47	14	120	4800	5,88
6304 ZZ ENC 200°C	20	52	15	140	4400	6,39
6305 ZZ ENC 200°C	25	62	17	225	4000	10,07
6306 ZZ ENC 200°C	30	72	19	350	3600	14,42
6307 ZZ ENC 200°C	35	80	21	450	3200	16,89
6308 ZZ ENC 200°C	40	90	23	620	2800	22,22
6309 ZZ ENC 200°C	45	100	25	830	2400	28,45
6310 ZZ ENC 200°C	50	110	27	1050	2000	33,78
6311 ZZ ENC 200°C	55	120	29	1350	1800	42,17
6312 ZZ ENC 200°C	60	130	31	1700	1600	46,22

6000 SERIES

Code	Inner diameter	Diameter (D)	Width (W)	Weight	Speed Revs./min.	Static charge Kn
6000 ENC ZZ 270°CL	10	26	8	20	300	1.34
6001 ENC ZZ 270°CL	12	28	8	25	275	1.61
6002 ENC ZZ 270°CL	15	32	9	30	255	1.94
6003 ENC ZZ 270°CL	17	35	10	40	230	2.21
6004 ENC ZZ 270°CL	20	42	12	69	225	3.40
6005 ENC ZZ 270°CL	25	47	12	80	190	3.98
6006 ENC ZZ 270°CL	30	55	13	120	150	5.44
6007 ENC ZZ 270°CL	35	62	14	160	125	7.07
6008 ENC ZZ 270°CL	40	68	15	190	115	8
6009 ENC ZZ 270°CL	45	75	16	250	100	9.73
6010 ENC ZZ 270°CL	50	80	16	260	95	10.61
6011 ENC ZZ 270°CL	55	90	18	390	85	14.42
6012 ENC ZZ 270°CL	60	95	18	420	80	15.80
6013 ENC ZZ 270°CL	65	100	18	440	70	17
6014 ENC ZZ 270°CL	70	110	20	600	65	21.42
6015 ENC ZZ 270°CL	75	115	20	640	60	23.12
6016 ENC ZZ 270°CL	80	125	22	850	55	26
6017 ENC ZZ 270°CL	85	130	22	890	55	27.9
6018 ENC ZZ 270°CL	90	140	24	1150	55	32.5

6200 SERIES

Code	Inner diameter	Diameter (D)	Width (W)	Weight	Speed Revs./min.	Static charge Kn
6200 ENC ZZ 270°CL	10	30	9	30	290	1.77
6201 ENC ZZ 270°CL	12	32	10	37	275	2.11
6202 ENC ZZ 270°CL	15	35	11	45	195	2.55
6203 ENC ZZ 270°CL	17	40	12	65	185	3.23
6204 ENC ZZ 270°CL	20	47	14	110	170	4.46
6205 ENC ZZ 270°CL	25	52	15	130	155	5.44
6206 ENC ZZ 270°CL	30	62	16	200	130	7.62
6207 ENC ZZ 270°CL	35	72	17	290	120	10
6208 ENC ZZ 270°CL	40	80	18	370	95	12.24
6209 ENC ZZ 270°CL	45	85	19	410	90	16.3
6210 ENC ZZ 270°CL	50	90	20	460	85	19.88
6211 ENC ZZ 270°CL	55	100	21	610	75	24.48
6212 ENC ZZ 270°CL	62	110	22	780	70	28.22
6213 ENC ZZ 270°CL	65	120	23	990	50	29.92
6214 ENC ZZ 270°CL	70	125	24	1040	50	33.32
6215 ENC ZZ 270°CL	75	130	25	1210	50	35.7
6216 ENC ZZ 270°CL	80	140	26	1400	50	41.6
6217 ENC ZZ 270°CL	85	150	28	1800	50	43.7
6218 ENC ZZ 270°CL	90	160	30	2150	50	52.9

6300 SERIES

Code	Inner diameter	Diameter (D)	Width (W)	Weight	Speed Revs./min.	Static charge Kn
6300 ENC ZZ 270°CL	10	35	11	52	225	2.34
6301 ENC ZZ 270°CL	12	37	12	60	210	2.82
6302 ENC ZZ 270°CL	15	42	13	80	190	3.67
6303 ENC ZZ 270°CL	17	47	14	120	165	4.46
6304 ENC ZZ 270°CL	20	52	15	140	150	5.78
6305 ENC ZZ 270°CL	25	62	17	225	110	7.75
6306 ENC ZZ 270°CL	30	72	19	350	95	11
6307 ENC ZZ 270°CL	35	80	21	450	85	12.92
6308 ENC ZZ 270°CL	40	90	23	620	75	17
6309 ENC ZZ 270°CL	45	100	25	830	67	21.76
6310 ENC ZZ 270°CL	50	110	27	1050	60	25
6311 ENC ZZ 270°CL	55	120	29	1350	53	32.30
6312 ENC ZZ 270°CL	60	130	31	1700	50	35.36
6313 ENC ZZ 270°CL	65	140	33	2100	50	40.8
6314 ENC ZZ 270°CL	70	150	35	2500	50	46
6315 ENC ZZ 270°CL	75	160	37	3000	50	52
6316 ENC ZZ 270°CL	80	170	39	3600	50	56.2
6317 ENC ZZ 270°CL	85	180	41	4250	50	62.7
6318 ENC ZZ 270°CL	90	190	43	4900	50	70.2



ENC ZZ 270°

TECHNICAL CHARACTERISTICS

- AISI 52100 Steel
- Manganese Phosphate surface treatment
- Increased radial clearance to compensate for thermal expansion
- Molyguard CF-2 grease from -35° C to 270°C
- ZZ and OPEN available

FIELDS OF USE

- Brick manufacturing kiln karts
- Ceramic industry kilnes
- High temperature rollers
- Steel manufacturing
- Glass manufacturing
- Etc.



ENC 2RS 250



When you need C4 PLAY with high temperature

CHOOSE THE

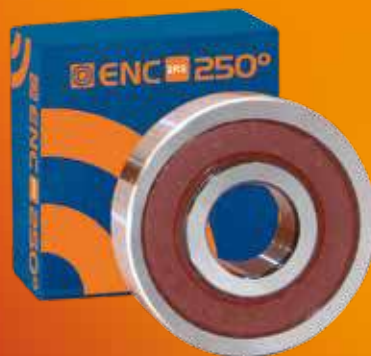

BLUE BOX

TECHNICAL SPECIFICATIONS:

- 52100 Steel
- C4 Radial Clearance
- Greased for -20 to 265C
- 2RS-265C Vulcanized Rubber Protection

APPLICATIONS:

- Textile Machinery
- Generators
- Heating Pumps
- Industrial Ventilators
- Dryers
- Etc.



 **BRL**
Bearings & Components

The color
bearings company

Tel.: (+34) 937 541 674 • www.brلبearings.com • brلب@brلبbearings.com

6000 SERIES

Code	Inner diameter	Diameter (D)	Width (W)	Weight	Speed Revs/min.	Static charge Kn
6000 2RS ENC 250°C	10	26	8	22	6.000	1,78
6001 2RS ENC 250°C	12	28	8	27	5.800	2,13
6002 2RS ENC 250°C	15	32	9	32	5.600	2,53
6003 2RS ENC 250°C	17	35	10	43	5.400	2,94
6004 2RS ENC 250°C	20	42	12	71	5.200	5,46
6005 2RS ENC 250°C	25	47	12	83	4.800	5,14
6006 2RS ENC 250°C	30	55	13	125	4.400	7,11
6007 2RS ENC 250°C	35	62	14	165	4.000	9,19
6008 2RS ENC 250°C	40	68	15	195	3.600	10,47
6009 2RS ENC 250°C	45	75	16	255	3.200	12,64
6010 2RS ENC 250°C	50	80	16	265	2.800	13,83

6200 SERIES

Code	Inner diameter	Diameter (D)	Width (W)	Weight	Speed Revs/min.	Static charge Kn
6200 2RS ENC 250°C	10	30	9	32	5.800	2,33
6201 2RS ENC 250°C	12	32	10	37	5.600	2,84
6202 2RS ENC 250°C	15	35	11	45	5.400	3,35
6203 2RS ENC 250°C	17	40	12	65	5.200	4,26
6204 2RS ENC 250°C	20	47	14	110	4.800	5,98
6205 2RS ENC 250°C	25	52	15	132	4.400	7,11
6206 2RS ENC 250°C	30	62	16	200	4.000	9,88
6207 2RS ENC 250°C	35	72	17	290	3.600	13,53
6208 2RS ENC 250°C	40	80	18	370	3.200	16
6209 2RS ENC 250°C	45	85	19	410	2.800	18,07
6210 2RS ENC 250°C	50	90	20	460	2.400	21,33

6300 SERIES

Code	Inner diameter	Diameter (D)	Width (W)	Weight	Speed Revs/min.	Static charge Kn
6300 2RS ENC 250°C	10	35	11	52	5.600	3,14
6301 2RS ENC 250°C	12	37	12	60	5.400	3,75
6302 2RS ENC 250°C	15	42	13	80	5.200	4,87
6303 2RS ENC 250°C	17	47	14	120	4.800	5,88
6304 2RS ENC 250°C	20	52	15	140	4.400	6,39
6305 2RS ENC 250°C	25	62	17	225	4.000	10,07
6306 2RS ENC 250°C	30	72	19	350	3.600	14,42
6307 2RS ENC 250°C	35	80	21	450	3.200	16,89
6308 2RS ENC 250°C	40	90	23	620	4.800	22,22
6309 2RS ENC 250°C	45	100	25	830	2.400	28,45
6310 2RS ENC 250°C	50	110	27	1050	2.000	33,78

2RS

ENC 2RS 250°C

TECHNICAL CHARACTERISTICS

- 52100 Steel
- C4 Radial Clearance
- Greased for -20 to 265C
- 2RS-265C Vulcanized Rubber Protection

FIELDS OF USE

- Textile Machinery
- Generators
- Heating Pumps
- Industrial Ventilators
- Dryers
- Etc.



ENC ZZ 270°



TECHNICAL CHARACTERISTICS

- AISI 52100 Steel
- Manganese Phosphate surface treatment
- Increased radial clearance to compensate for thermal expansion
- Klüber's Barrierta LT 55/2 grease from -30° C to 270°
- ZZ shields

FIELDS OF USE

- Brick manufacturing kiln karts
- Ceramic industry kilnes
- High temperature rollers
- Steel manufacturing
- Iron and steel industry
- Glass manufacturing
- Etc.



6000 SERIES

Code	Inner diameter	Diameter (D)	Width (W)	Weight	Speed Revs/min.	Static charge Kn
6000 ENC ZZ 270°C	10	26	8	20	2300	1.14
6001 ENC ZZ 270°C	12	28	8	25	2090	1.37
6002 ENC ZZ 270°C	15	32	9	30	1930	1.65
6003 ENC ZZ 270°C	17	35	10	40	1790	1.88
6004 ENC ZZ 270°C	20	42	12	69	1620	2.89
6005 ENC ZZ 270°C	25	47	12	80	1375	3.38
6006 ENC ZZ 270°C	30	55	13	120	1060	4.62
6007 ENC ZZ 270°C	35	62	14	160	895	6.01
6008 ENC ZZ 270°C	40	68	15	190	820	6.80
6009 ENC ZZ 270°C	45	75	16	250	730	8.27
6010 ENC ZZ 270°C	50	80	16	260	690	9.02
6011 ENC ZZ 270°C	55	90	18	390	615	12.26
6012 ENC ZZ 270°C	60	95	18	420	570	13.43
6013 ENC ZZ 270°C	65	100	18	440	510	14.45
6014 ENC ZZ 270°C	70	110	20	600	495	18.21
6015 ENC ZZ 270°C	75	115	20	640	460	19.65
6016 ENC ZZ 270°C	80	125	22	850	410	22.1
6017 ENC ZZ 270°C	85	130	22	890	395	23.7
6018 ENC ZZ 270°C	90	140	24	1150	375	27.6

6200 SERIES

Code	Inner diameter	Diameter (D)	Width (W)	Weight	Speed Revs/min.	Static charge Kn
6200 ENC ZZ 270°C	10	30	9	30	2100	1.50
6201 ENC ZZ 270°C	12	32	10	37	1950	1.79
6202 ENC ZZ 270°C	15	35	11	45	1650	2.17
6203 ENC ZZ 270°C	17	40	12	65	1460	2.75
6204 ENC ZZ 270°C	20	47	14	110	1225	3.79
6205 ENC ZZ 270°C	25	52	15	130	1150	4.62
6206 ENC ZZ 270°C	30	62	16	200	895	6.48
6207 ENC ZZ 270°C	35	72	17	290	775	8.50
6208 ENC ZZ 270°C	40	80	18	370	695	10.40
6209 ENC ZZ 270°C	45	85	19	410	650	11.79
6210 ENC ZZ 270°C	50	90	20	460	615	13.86
6211 ENC ZZ 270°C	55	100	21	610	540	16.90
6212 ENC ZZ 270°C	62	110	22	780	485	20.81
6213 ENC ZZ 270°C	65	120	23	990	430	23.99
6214 ENC ZZ 270°C	70	125	24	1040	415	25.43
6215 ENC ZZ 270°C	75	130	25	1210	390	28.32
6216 ENC ZZ 270°C	80	140	26	1400	365	30.3
6217 ENC ZZ 270°C	85	150	28	1800	340	35.3
6218 ENC ZZ 270°C	90	160	30	2150	320	40.5

6300 SERIES

Code	Inner diameter	Diameter (D)	Width (W)	Weight	Speed Revs/min.	Static charge Kn
6300 ENC ZZ 270°C	10	35	11	52	1790	1.99
6301 ENC ZZ 270°C	12	37	12	60	1650	2.40
6302 ENC ZZ 270°C	15	42	13	80	1460	3.12
6303 ENC ZZ 270°C	17	47	14	120	1295	3.79
6304 ENC ZZ 270°C	20	52	15	140	1140	4.91
6305 ENC ZZ 270°C	25	62	17	225	895	6.59
6306 ENC ZZ 270°C	30	72	19	350	775	9.35
6307 ENC ZZ 270°C	35	80	21	450	695	10.98
6308 ENC ZZ 270°C	40	90	23	620	615	14.45
6309 ENC ZZ 270°C	45	100	25	830	545	18.50
6310 ENC ZZ 270°C	50	110	27	1050	495	21.25
6311 ENC ZZ 270°C	55	120	29	1350	440	27.46
6312 ENC ZZ 270°C	60	130	31	1700	415	30.06
6313 ENC ZZ 270°C	65	140	33	2100	375	34.68
6314 ENC ZZ 270°C	70	150	35	2500	360	39.10
6315 ENC ZZ 270°C	75	160	37	3000	335	44.20
6316 ENC ZZ 270°C	80	170	39	3600	325	47.70
6317 ENC ZZ 270°C	85	180	41	4250	310	53.20
6318 ENC ZZ 270°C	90	190	43	4900	290	59.60

6000 SERIES

Code	Inner diameter	Diameter (D)	Width (W)	Weight	Speed Revs./min.	Static charge Kn
6000 ENC ZZ 330°C	10	26	8	20	295	1.14
6001 ENC ZZ 330°C	12	28	8	25	275	1.37
6002 ENC ZZ 330°C	15	32	9	30	265	1.65
6003 ENC ZZ 330°C	17	35	10	40	250	1.88
6004 ENC ZZ 330°C	20	42	12	69	240	2.89
6005 ENC ZZ 330°C	25	47	12	80	180	3.38
6006 ENC ZZ 330°C	30	55	13	120	150	4.62
6007 ENC ZZ 330°C	35	62	14	160	125	6.01
6008 ENC ZZ 330°C	40	68	15	190	115	6.80
6009 ENC ZZ 330°C	45	75	16	250	100	8.27
6010 ENC ZZ 330°C	50	80	16	260	90	9.02
6011 ENC ZZ 330°C	55	90	18	390	85	12.26
6012 ENC ZZ 330°C	60	95	18	420	80	13.43
6013 ENC ZZ 330°C	65	100	18	440	70	14.45
6014 ENC ZZ 330°C	70	110	20	600	68	18.21
6015 ENC ZZ 330°C	75	115	20	640	63	19.65
6016 ENC ZZ 330°C	80	125	22	850	55	22.1
6017 ENC ZZ 330°C	85	130	22	890	55	23.7
6018 ENC ZZ 330°C	90	140	24	1150	55	27.6

6200 SERIES

Code	Inner diameter	Diameter (D)	Width (W)	Weight	Speed Revs./min.	Static charge Kn
6200 ENC ZZ 330°C	10	30	9	30	275	1.50
6201 ENC ZZ 330°C	12	32	10	37	265	1.79
6202 ENC ZZ 330°C	15	35	11	45	250	2.17
6203 ENC ZZ 330°C	17	40	12	65	220	2.75
6204 ENC ZZ 330°C	20	47	14	110	170	3.79
6205 ENC ZZ 330°C	25	52	15	130	160	4.62
6206 ENC ZZ 330°C	30	62	16	200	120	6.48
6207 ENC ZZ 330°C	35	72	17	290	110	8.50
6208 ENC ZZ 330°C	40	80	18	370	95	10.40
6209 ENC ZZ 330°C	45	85	19	410	90	11.79
6210 ENC ZZ 330°C	50	90	20	460	80	13.86
6211 ENC ZZ 330°C	55	100	21	610	70	16.90
6212 ENC ZZ 330°C	62	110	22	780	65	20.81
6213 ENC ZZ 330°C	65	120	23	990	60	23.99
6214 ENC ZZ 330°C	70	125	24	1040	55	25.43
6215 ENC ZZ 330°C	75	130	25	1210	55	28.32
6216 ENC ZZ 330°C	80	140	26	1400	50	30.3
6217 ENC ZZ 330°C	85	150	28	1800	50	35.3
6218 ENC ZZ 330°C	90	160	30	2150	50	40.5

6300 SERIES

Code	Inner diameter	Diameter (D)	Width (W)	Weight	Speed Revs./min.	Static charge Kn
6300 ENC ZZ 330°C	10	35	11	52	230	1.99
6301 ENC ZZ 330°C	12	37	12	60	220	2.40
6302 ENC ZZ 330°C	15	42	13	80	190	3.12
6303 ENC ZZ 330°C	17	47	14	120	175	3.79
6304 ENC ZZ 330°C	20	52	15	140	160	4.91
6305 ENC ZZ 330°C	25	62	17	225	150	6.59
6306 ENC ZZ 330°C	30	72	19	350	115	9.35
6307 ENC ZZ 330°C	35	80	21	450	90	10.98
6308 ENC ZZ 330°C	40	90	23	620	80	14.45
6309 ENC ZZ 330°C	45	100	25	830	75	18.50
6310 ENC ZZ 330°C	50	110	27	1050	65	21.25
6311 ENC ZZ 330°C	55	120	29	1350	60	27.46
6312 ENC ZZ 330°C	60	130	31	1700	55	30.06
6313 ENC ZZ 330°C	65	140	33	2100	50	34.68
6314 ENC ZZ 330°C	70	150	35	2500	45	39.10
6315 ENC ZZ 330°C	75	160	37	3000	45	44.20
6316 ENC ZZ 330°C	80	170	39	3600	45	47.70
6317 ENC ZZ 330°C	85	180	41	4250	45	53.20
6318 ENC ZZ 330°C	90	190	43	4900	45	59.60

ZZ

OPEN

ENC ZZ 330°

TECHNICAL CHARACTERISTICS

- AISI 52100 Steel
- Manganese Phosphate surface treatment
- Increased radial clearance to compensate expansions
- Klüber's Wolfrasin ULAF 60 grease up to 330°
- ZZ and OPEN available

FIELDS OF USE

- Brick manufacturing kiln karts
- High temperature rollers
- Iron and steel industry
- Glass manufacturing
- Etc.



2RS



TECHNICAL CHARACTERISTICS

- Stainless steel
- Standard radial play
- Rubber 2rs shields
- Lubricated

FIELDS OF USE

- Applications with a high level of humidity



6000 SERIES

Code	Inner diameter (d)	Diameter (D)	Width (B)	Weight	Speed Revs/min	Static Charge Kn
6000 2RS ENC INOX	10	26	8	20	20.000	1,61
6001 2RS ENC INOX	12	28	8	25	16.750	1,93
6002 2RS ENC INOX	15	32	9	30	15.500	2,33
6003 2RS ENC INOX	17	35	10	40	14.500	2,66
6004 2RS ENC INOX	20	42	12	69	13.000	4,09
6005 2RS ENC INOX	25	47	12	80	11.000	4,79
6006 2RS ENC INOX	30	55	13	120	8.750	6,55
6007 2RS ENC INOX	35	62	14	160	7.200	8,51
6008 2RS ENC INOX	40	68	15	190	6.500	9,66
6009 2RS ENC INOX	45	75	16	250	5.900	11,70
6010 2RS ENC INOX	50	80	16	260	5.600	12,77
6011 2RS ENC INOX	55	90	18	390	4.900	17,35
6012 2RS ENC INOX	60	95	18	420	4.500	18,93
6013 2RS ENC INOX	65	100	18	440	4.250	20,46
6014 2RS ENC INOX	70	110	20	600	4.000	25,78
6015 2RS ENC INOX	75	115	20	640	3.650	27,83

6200 SERIES

Code	Inner diameter (d)	Diameter (D)	Width (B)	Weight	Speed Revs/min	Static Charge Kn
6200 2RS ENC INOX	10	30	9	36	17.120	2,13
6201 2RS ENC INOX	12	32	10	41	14.338	2,54
6202 2RS ENC INOX	15	35	11	49	13.268	3,07
6203 2RS ENC INOX	17	40	12	69	12.412	3,89
6204 2RS ENC INOX	20	47	14	150	11.128	5,36
6205 2RS ENC INOX	25	52	15	170	9.416	6,55
6206 2RS ENC INOX	30	62	16	240	7.490	9,17
6207 2RS ENC INOX	35	72	17	330	6.163	12,52
6208 2RS ENC INOX	40	80	18	410	5.564	14,73
6209 2RS ENC INOX	45	85	19	460	5.050	16,70
6210 2RS ENC INOX	50	90	20	500	4.794	19,64
6211 2RS ENC INOX	55	100	21	650	4.194	23,73
6212 2RS ENC INOX	60	110	22	820	3.852	29,46
6213 2RS ENC INOX	65	120	23	990	3.638	33,96
6214 2RS ENC INOX	70	125	24	1040	3.424	36,01
6215 2RS ENC INOX	75	130	25	1210	3.124	40,10

6300 SERIES

Code	Inner diameter (d)	Diameter (D)	Width (B)	Weight	Speed Revs/min	Static Charge Kn
6300 2RS ENC INOX	10	35	11	57	14.250	2,82
6301 2RS ENC INOX	12	37	12	64	12.900	3,40
6302 2RS ENC INOX	15	42	13	86	11.600	4,42
6303 2RS ENC INOX	17	47	14	160	10.300	5,67
6304 2RS ENC INOX	20	52	15	180	9.050	6,96
6305 2RS ENC INOX	25	62	17	270	7.100	9,33
6306 2RS ENC INOX	30	72	19	390	6.100	13,34
6307 2RS ENC INOX	25	80	21	500	5.550	15,55
6308 2RS ENC INOX	40	90	23	670	4.900	20,46
6309 2RS ENC INOX	45	100	25	870	4.300	26,19
6310 2RS ENC INOX	50	110	27	1090	3.950	31,10
6311 2RS ENC INOX	55	124	29	1390	3.425	38,87
6312 2RS ENC INOX	60	130	31	1740	3.250	42,56
6313 2RS ENC INOX	65	140	33	2100	2.990	49,10
6314 2RS ENC INOX	70	150	35	2500	2.825	57,49
6315 2RS ENC INOX	75	160	37	3000	1.600	62,61

UC FOR HIGHT TEMPERATURE

ZZ

Bearing No.	Shaft Dia.		Dimensions(mm)						Basic Dynamic Load Rating (kg)	Basic Static Load Rating (kg)	Weight (kg)	Turns per minute
	d(mm)	D	Bi	Be	n	m	G	ds				
UC 201	12	47	31	17	12,7	18,3	4,8	M6X1.0	1000	630	0,21	275
UC 202	15	47	31	17	12,7	18,3	4,8	M6X1.0	1000	630	0,19	195
UC 203	17	47	31	17	12,7	18,3	4,8	M6X1.0	1000	630	0,18	185
UC 204	20	47	31	17	12,7	18,3	4,8	M6X1.0	1000	630	0,16	170
UC 205	25	52	34	17	14,3	19,7	5,5	M6X1.0	1100	710	0,2	155
UC 206	30	62	38,1	19	15,9	22,2	6	M6X1.0	1520	1020	0,32	130
UC 207	35	72	42,9	20	17,5	25,4	6,5	M8X1.0	2010	1390	0,48	100
UC 208	40	80	49,2	21	19	30,2	8	M8X1.0	2560	1810	0,64	95
UC 209	45	85	49,2	22	19	30,2	8	M8X1.0	2560	1810	0,68	90
UC 210	50	90	51,6	24	19	32,6	10	M10X1.0	2750	2020	0,8	85

UC 270°

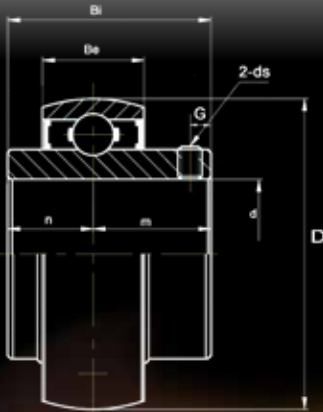

TECHNICAL CHARACTERISTICS

- AISI 52100 Steel
- Manganese Phosphate surface treatment
- Increased radial clearance to compensate for thermal expansion
- Molyguard CF-2 grease from -35° C to 270°C

FIELDS OF USE

- Brick manufacturing kiln karts
- Ceramic industry kilnes
- High temperature rollers
- Steel manufacturing
- Glass manufacturing
- Etc.





The company that brings
colour to temperature

BRL Bearings, S.L.

✍ Plaça Can Pau Ferrer 8 Bloc D Baixos
08349 Cabrera De Mar
BARCELONA - SPAIN

📞 (+34) 937 54 16 74
📠 (+34) 937 54 16 75
🌐 www.brlbearings.com
✉ brl@brlbearings.com

Distributor: